

Project: _____	AIA# _____
Item #: _____ Qty: _____	SIS# _____
Model #: _____	

## Lighted Liquor Displays



LLD2



LLD3



LLDG

### Two Tier Models

LLD2-24, LLD2-30, LLD2-36, LLD2-42,  
 LLD2-48, LLD2-54, LLD2-60

### Three Tier Models

LLD3-24, LLD3-30, LLD3-36, LLD3-42,  
 LLD3-48, LLD3-54, LLD3-60

### Glass Ice Display Unit Models

LLDG-24, LLDG-30, LLDG-36, LLDG-42,  
 LLDG-48, LLDG-54, LLDG-60

### LLD Configurable Options

#### **Power Cord Style:**

- Type B - NEMA 5-15P (Default - North America)
- Type F (Europe)
- Type M (India)

#### **Power Cord Location:**

- Left or Right

#### **Exterior Finish:**

- Black vinyl-clad
- Stainless steel

#### **LED Lighting:**

- Bright white
- Warm white
- Adjustable multi-color

### Standard Features

- Long lasting LED lighting
- On/off switch conveniently located on same side as power cord
- Available with two (LLD2 models) or three (LLD3 models) 4" high by 4" deep steps
- LLDG models have two steps and are designed for use in conjunction with Glastender Glass Ice Display Units. The first step is 9-1/4" high and a front light channel helps to illuminate the ice display.

### Specifications

#### *Electrical*

- 100-240 VAC, 1 phase, 50/60Hz, less than 2 full load amps
- Includes on/off switch and 6-foot grounded cord and plug located on the left or right side as specified at time of order
- Adjustable multi-color option includes manual knob for color selection on same side as cord

#### *Materials*

- Black vinyl-clad steel parts include: standard front, back, and sides
- Stainless steel parts include: bottom, optional front, back, and sides
- Top consists of 1/8" thick opaque acrylic

<b>Glastender, Inc.</b> • 5400 N Michigan Rd • Saginaw, MI • 48604-9780 989.752.4275 • 800.748.0423 • Fax 989.752.4444 <a href="http://www.glastender.com">www.glastender.com</a>	Approval/Notes:
Specifications subject to change without notice. For current specifications please visit our website.	

# Lighted Liquor Displays

## Dimensional Information

### Dimensional Details for LLD2 Models

PLAN VIEW

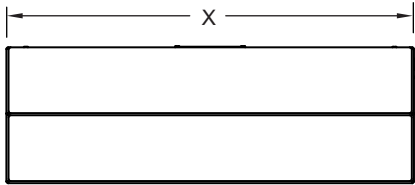

X = 24", 30", 36", 42", 48", 54", or 60"

FRONT VIEW



SIDE VIEW  
(IF POWERCORD RIGHT)

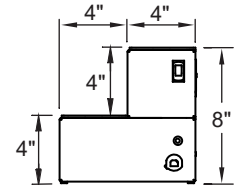

### Dimensional Details for LLD3 Models

PLAN VIEW

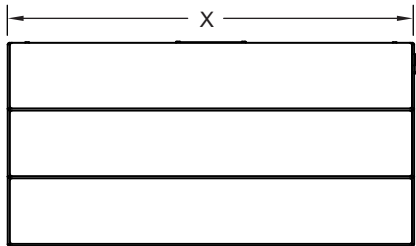

X = 24", 30", 36", 42", 48", 54", or 60"

FRONT VIEW



SIDE VIEW  
(IF POWERCORD RIGHT)

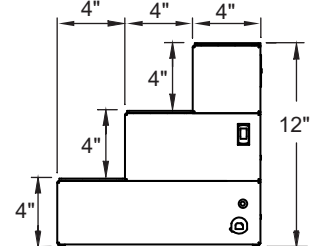

### Dimensional Details for LLDG Models

PLAN VIEW

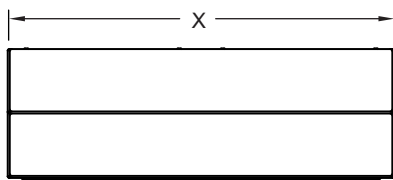

X = 24", 30", 36", 42", 48", 54", or 60"

FRONT VIEW

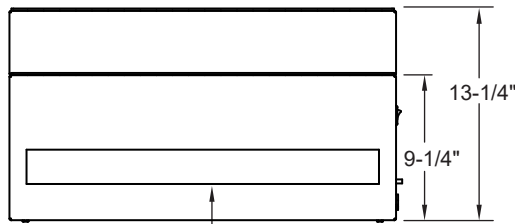

CLEAR ACRYLIC FRONT PANEL

SIDE VIEW  
(IF POWERCORD RIGHT)

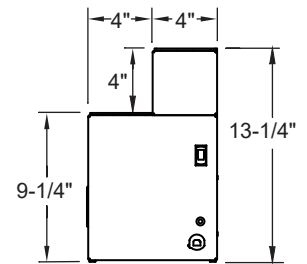

LLDG models are designed for use with Glastender Glass Ice Display Units. The 9-1/4" high first step of the LLDG raises the bottles above the back of the GDU and the front light channel helps to illuminate the GDU. (See the side view detail.)

SIDE VIEW OF LLDG WITH 16" DEEP GLASS DISPLAY UNIT

