



PRODUCT INFORMATION
(see F1FB Spec Sheet for complete details)

STANDARD FEATURES:

- Self-contained
- All stainless steel interior construction
- Models with door include three coated adjustable shelves
- Listed to NSF Standard 7

F1FB36 with compressor left and stainless steel door and top

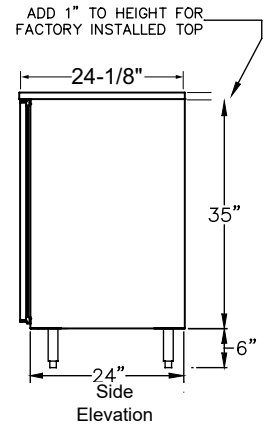

*NOTE: F1FB units are manufactured to order and are not returnable.

FROSTERS - ONE ZONE, FRONT SERVICED, BAR PROFILE

MODEL	LIST	LENGTH	DOOR		WEIGHT	AMPS	HP	10 Oz.	6" High
			DOORS	OPENING				MUGS	PINTGLASSES
F1FB32	\$7,668	32"	1	16" W	235#	6.5	1/3	120	96
F1FB36	\$7,754	36"	1	20" W	250#	6.5	1/3	168	120

Base price only. See next page for configurable options.

Bar Refrigeration



DIP-18 shown
Pans not included

ACCESSORIES

MODEL	DESCRIPTION	LIST
DIP-20	Drawer insert for fractional stainless pans, 20" door opening (pans not included)	\$287



Capable of storing specialty cocktail ice

*NOTE: F1FB units are manufactured to order and are not returnable.

Select Configurable Options:

VOLTAGE	
120V/60HZ	No charge
220V/50HZ (export voltage)	\$307

REFRIGERATION COMPARTMENT LOCATION	
Left	No charge
Right	No charge

REFRIGERATION COMPARTMENT COVER FINISH	
Black vinyl-clad	No charge
Unlaminated	No charge
Stainless steel	\$39
Jeweled stainless steel	\$232
Laminated	\$270

DOOR/DRAWER OPTIONS
NOTE: Select options for EACH Door/Drawer Section

STYLE AND FINISH - PER SECTION	
Door - Black vinyl-clad	No charge
Door - Unlaminated	No charge
Door - Stainless steel	\$48
Door - Jeweled stainless	\$252
Door - Laminated	\$288
Door - Glass, black vinyl-clad	\$734
Door - Glass, stainless steel	\$782
Door - Glass, jeweled stainless	\$986
Door - Glass, laminated	\$1,022
Drawers - Black vinyl-clad	\$2,381
Drawers - Unlaminated	\$2,381
Drawers - Stainless steel	\$2,429
Drawers - Jeweled stainless	\$2,633
Drawers - Laminated	\$2,669

DOOR HINGE LOCATION - PER DOOR	
Left	No charge
Right	No charge

DOOR HANDLE - PER DOOR/DRAWER	
Signature handle (doors only)	No charge
Pull-tab handle - stainless or black to match door; black for laminate	No charge
Tube handle	No charge



Optional drawers include adjustable divider walls



Drawer pull-tab handle

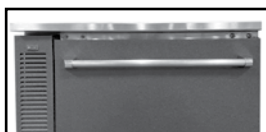

Drawer tube handle

TOP STYLE		
	32"	36"
No finished top		No charge
Stainless top	\$493	\$519

LEFT SIDE FINISH	
Black vinyl-clad	No charge
Stainless Steel	\$48

RIGHT SIDE FINISH	
Black vinyl-clad	No charge
Stainless Steel	\$48

BACK FINISH		
	32"	36"
Galvanized steel		No charge
Stainless steel*	\$392	\$404

*NOTE: Stainless steel back option also includes stainless steel sides.

LED LIGHTING STYLE	
Bright white (7,000k), standard	No charge
Warm white (3,500k)	No charge
Amber (2,700k)	No charge
Blue	No charge

LEG AND STAINLESS STEEL KICK RAILS		
NOTE: Legs are required if kick rails are ordered.		
	32"	36"
6" legs	\$253	\$253
Front kick rail	\$137	\$142
Left side kick rail	\$127	\$127
Right side kick rail	\$127	\$127

CASTERS		
	32"	36"
4-1/8" casters	\$223	\$223
2-7/8" casters	\$220	\$220
1-1/2" casters	\$387	\$387



Signature handle



Pull-tab handle



Tube handle

Bar Refrigeration