

Glastender[®]

MODULAR BAR DIE

Equipment Specification + Installation Guide



Introduction to Modular Bar Die

Modular bar die is a utility distribution wall which underbar equipment is mounted, providing a more durable, clean, and attractive alternate to site-built bar structures. Pre-assembled sections lend to ease of installation, reduced labor costs, and the structure design offers options for quick access to plumbing and electrical systems for maintenance.

Installation Ease

- Pre-engineered to exact dimensions to ensure precise fit.
- 48" wide, full-scale vinyl roll template available for equipment layout assistance.
- Millwork bar top and finish panels can be pre-fabricated and easily attached.

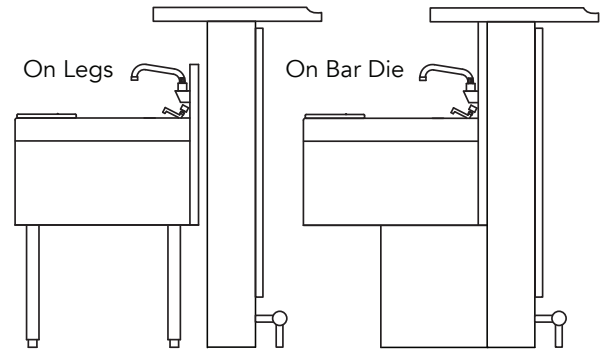

Reduced Labor Costs

- Arrives pre-assembled in sections up to 6' long for quicker installation - simply attach the sections, level, and secure to the floor.
- Removable finishing panels (provided by millworker) lend easy access to beverage, plumbing, and electrical lines for simple installation and maintenance.

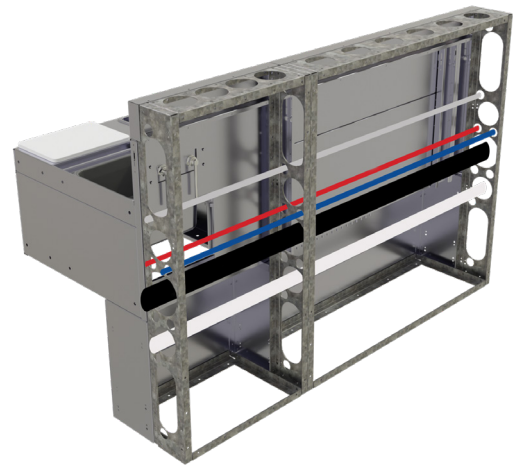

Clean & Polished Bars

- Elimination of underbar legs results in easier-to-clean bar floors.
- Built-in chaseways keep beverage and utility lines out of sight for a polished look.
- Equipment can be sealed to the floor to prevent bartender-side spills from seeping to customer side.



Specifications

Highlights:

- 16-gauge galvanized steel structure provides strength and rot resistance.
- 20-gauge stainless steel finishing on bartender side is sanitary and easy to clean.
- 20A GFI outlets and LED lighting are built into bar die wall based on customer preference (wiring not provided).

Bar Die Chaseway Detail

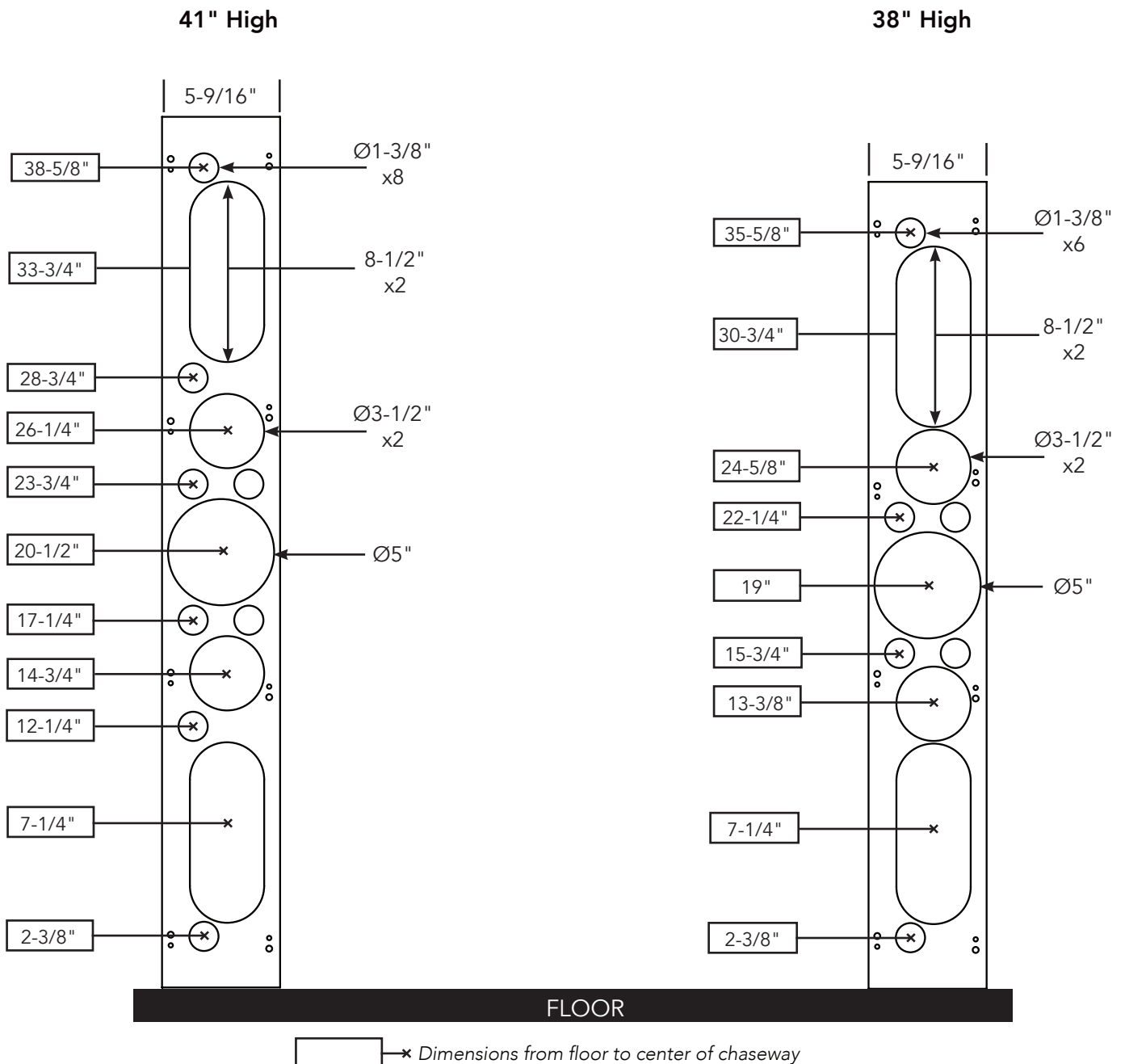

Note: Custom heights available on request

Example Plan Views

Plan View with Equipment

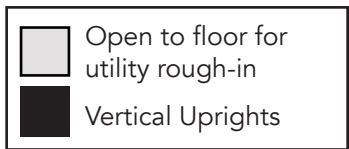
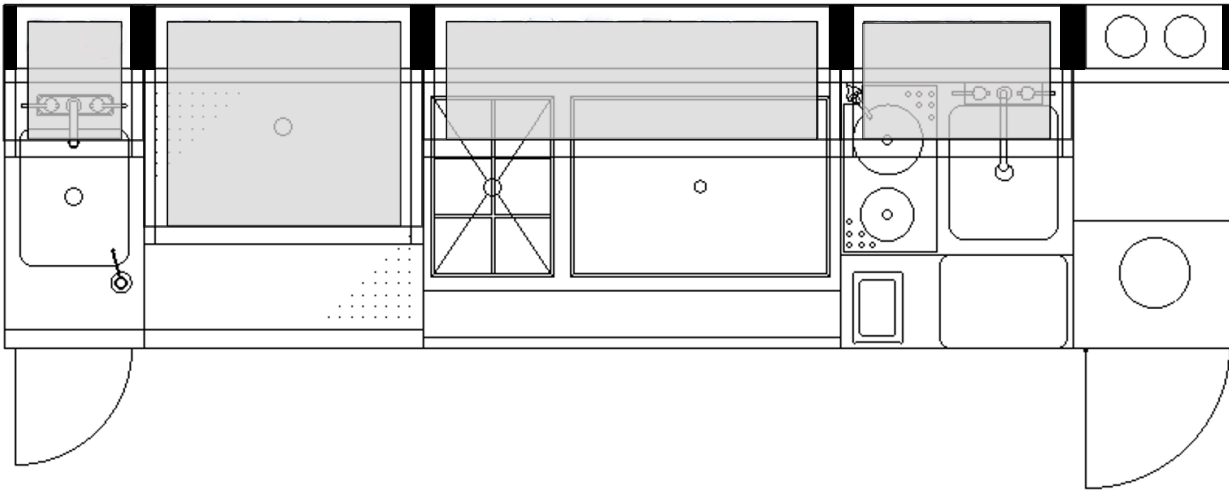

Plan View with Equipment Hidden

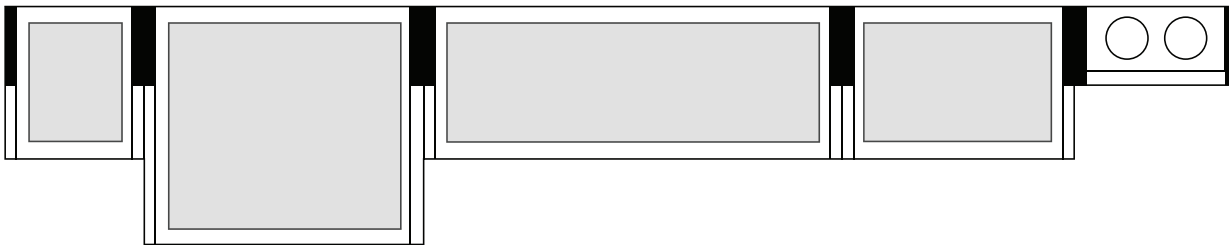

Front Elevation View

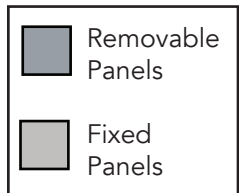
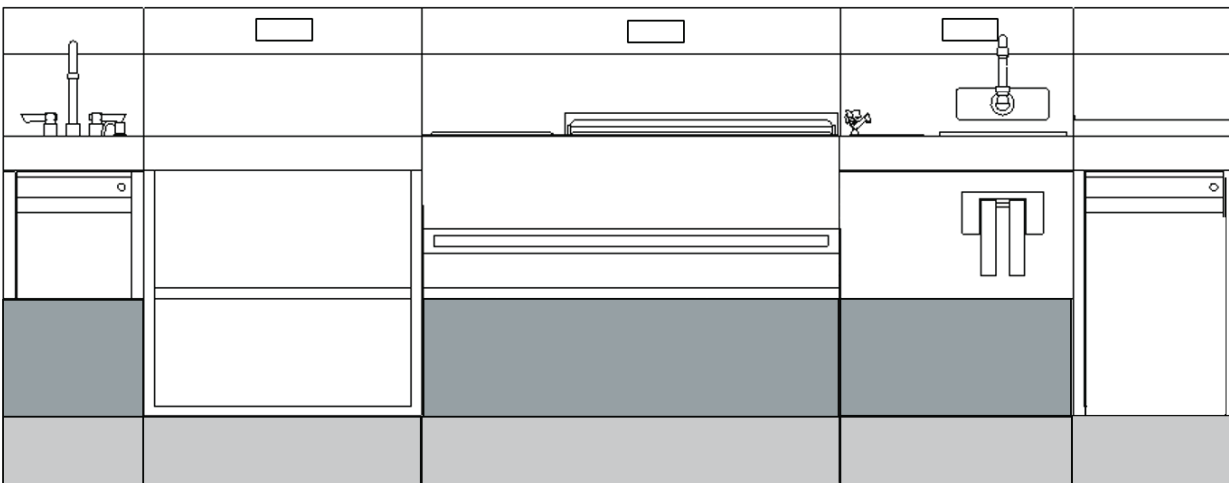

Bar Die Base Styles

Pedestal Base - For use with equipment typically on 16" legs, such as ice bins, sinks, liquor steps, etc.

Front Perspective View:

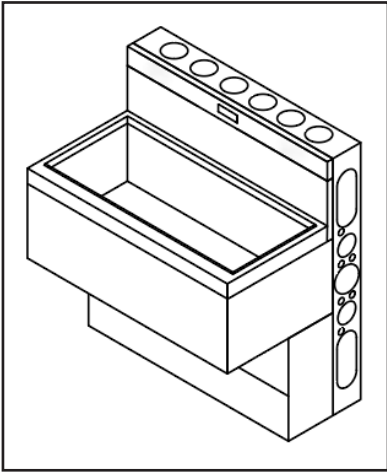

Back Perspective View:

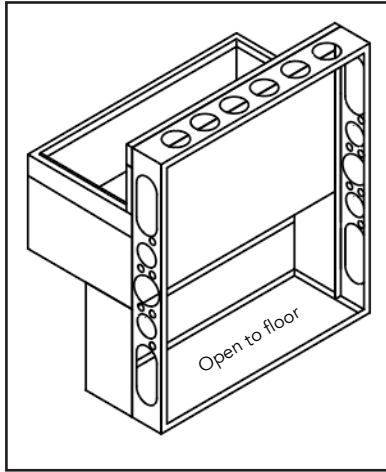

Side Elevation:

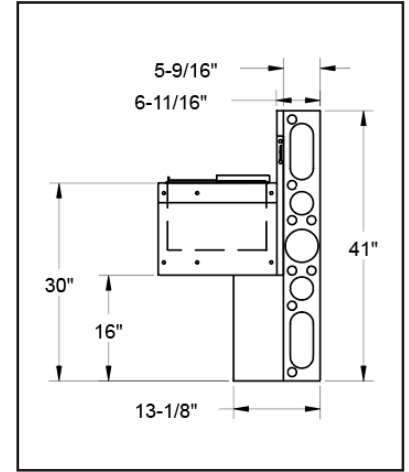

Cabinet Base - For use with equipment typically on 6" legs, such as cabinets and glass racks.

Front Perspective View:

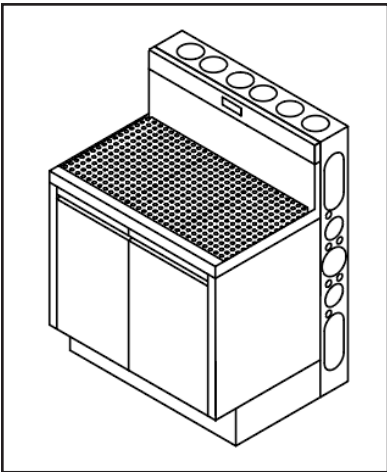

Back Perspective View:

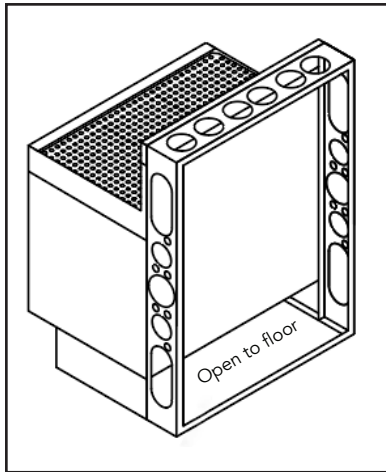

Side Elevation:

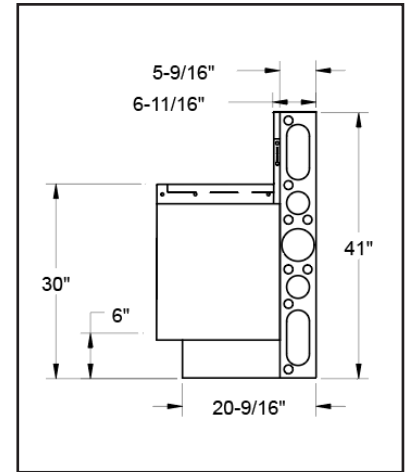

Flat Wall - For use with freestanding equipment, such as coolers, glasswashers, frosters, etc.

Front Perspective View:

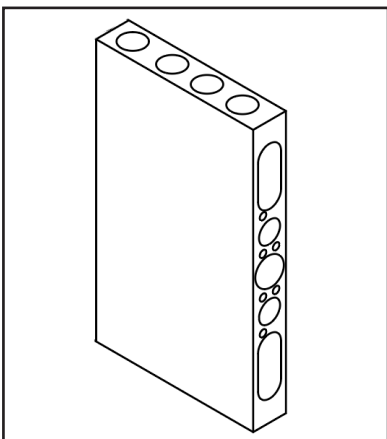

Back Perspective View:

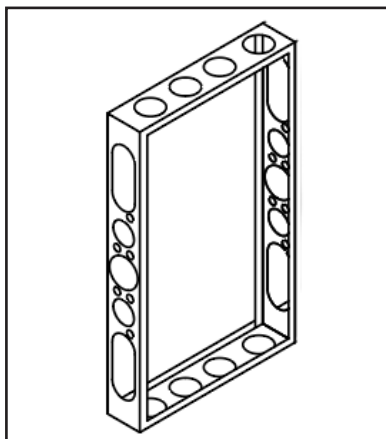

Allow 1/2" extra length, or more, depending on required clearance and airflow for said freestanding unit.

Note: Minimum 4" length.

Best Practices + Recommendations

Orders include an installation "footprint" to show the dimensions of the bar die where it meets the floor. This drawing is used as a reference in the field for placement of soda, beer, plumbing, and electrical rough-ins prior to delivery of the equipment. You can order a full-size template if you need further layout assistance.

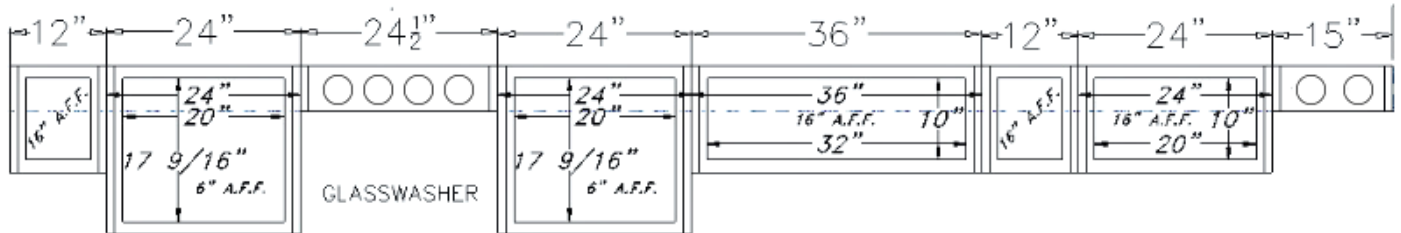

Electrical - 20A GFI outlets and LED lights are located where specified by the customer and noted on the drawing. Note: Wiring not included, all connections made by others.

Plumbing - Individual model specs contain plumbing waste and supply connection requirements. *Do not* extend floor sinks into the bar die base. For sanitation considerations, floor sinks should be fully accessible from the bartender side for cleaning and inspection.

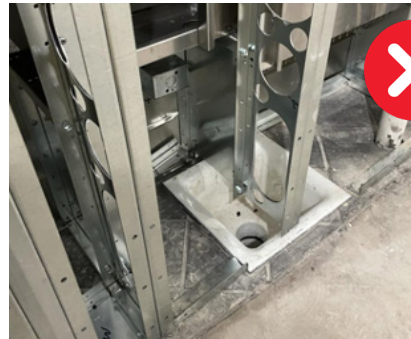

Bar Top & Millwork - It is strongly recommended to fasten the sub top to the bar die with material-appropriate hardware, at the holes located at or directly next to the vertical uprights wherever possible.

When properly installed, bar die accepts a wide range of bar top and finishing panel options. Given this wide variation, it is critical that the designer and fabricator/installer follow material-specific guidelines for proper adhesion, connection, and support to ensure a robust installation.

Site Flooring - Mount modular bar die to a clean, stable, and level floor meeting all applicable building codes. Install prior to finish flooring to improve the effectiveness of sealing at the floor.

The bartender side has a 6" fixed, non-removable base to cove flooring onto the bar die without interfering with removable panels.

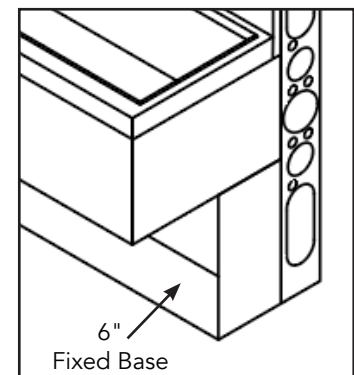

Modular Bar Die Installation Steps

Required Tools:

- Included hardware kit
- Level
- Philips screwdriver
- Shim stock
- Chalk line
- Ratchet wrench
- Powerdrill
- Tape measure

Material Appropriate Fasteners:

- Wood Flooring:
1/4" x 1-1/2" lag screws
- Concrete Flooring:
1/4" x 1-1/4" Tapcon thread cutting anchors or
1/4"-20 x 1-3/4" Trubolt wedge anchors

Step 1: Inspect

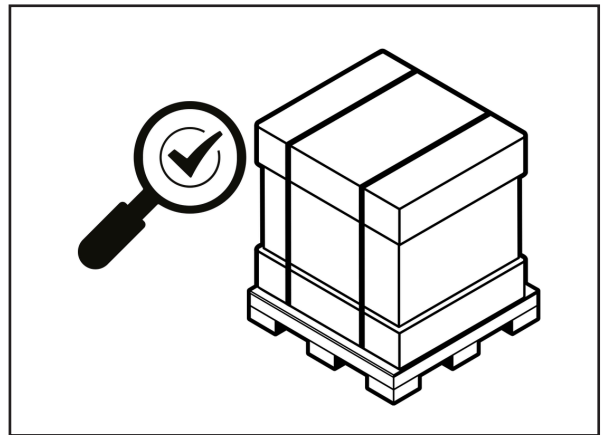

Inspect freight for damage upon delivery.

Step 2: Unbox

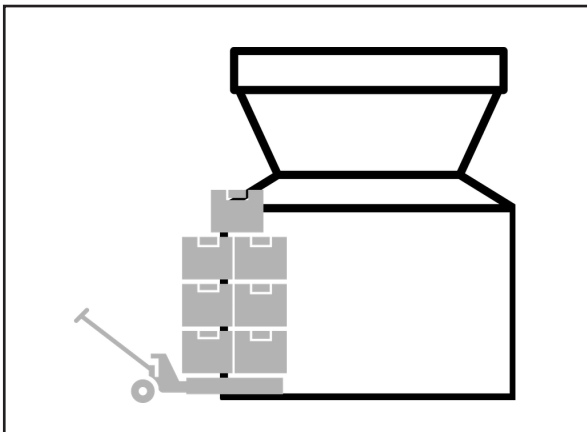

Move to bar area and begin carefully unboxing equipment.

Step 3: Arrange

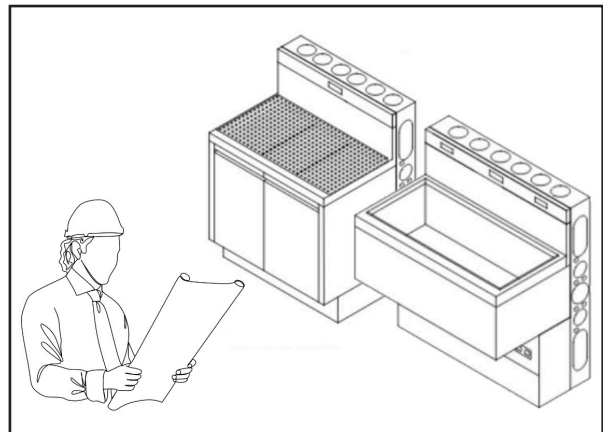

Equipment is numbered. Refer to provided footprint to begin arranging pieces in order.

Step 4: Loosely Connect

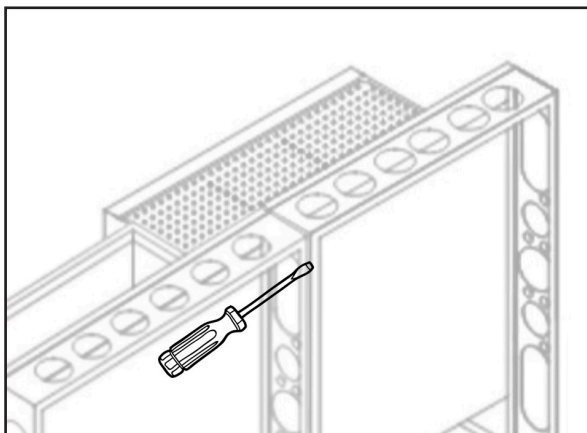

Use pre-punched bar die screw holes in the vertical studs and appropriate hardware to loosely connect equipment.

Step 5: Level & Shim

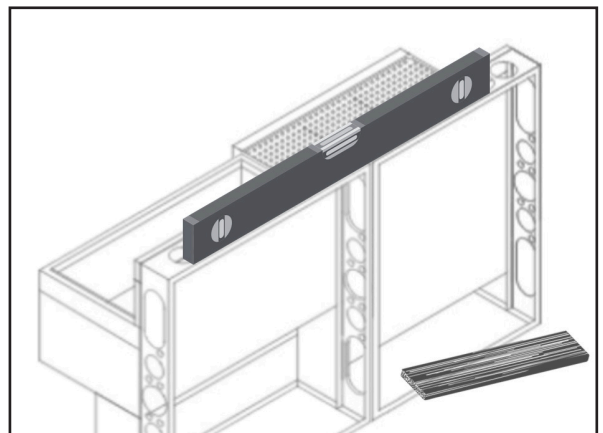

While screws are still loose, use metal or composite shims to level bar die ensuring stable and square installation.

Modular Bar Die Installation Steps (continued)

Step 6: Tighten Connections

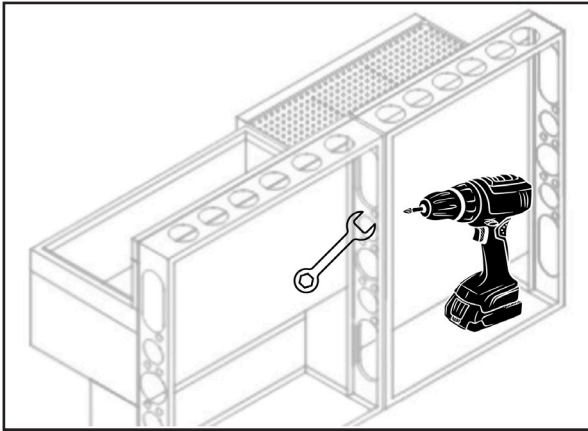

Screws and bolts can now be tightened.

Step 7: Seal Seams

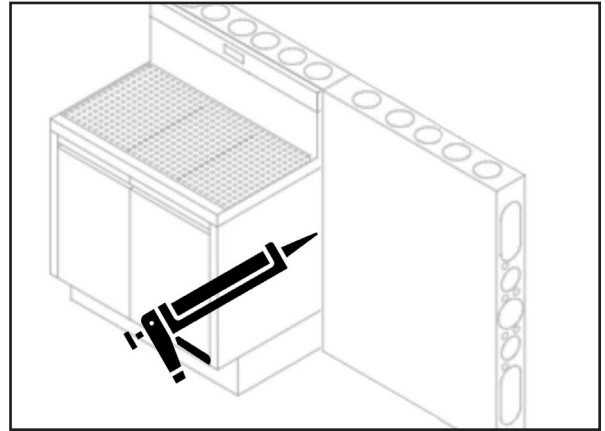

Seal all joints between units with NSF sealant.

Step 8: Fasten & Anchor

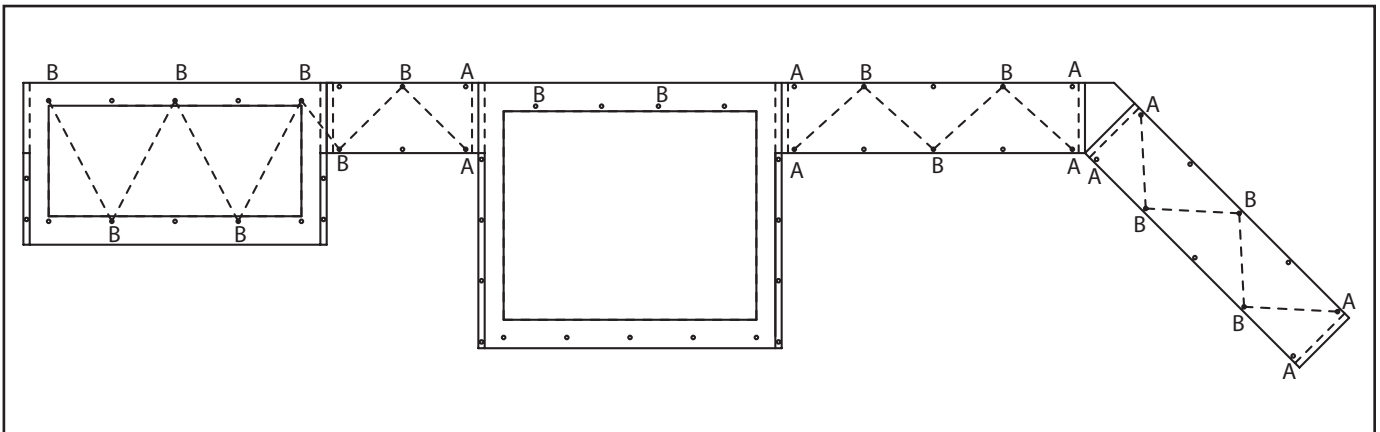

Using ¼" pre-punched base holes, fasten bar die using material-appropriate fasteners and/or anchors. Install fasteners in each corner of unconstrained ends (A), then zig-zag every other hole as shown (B).

Step 9: Utility Connections

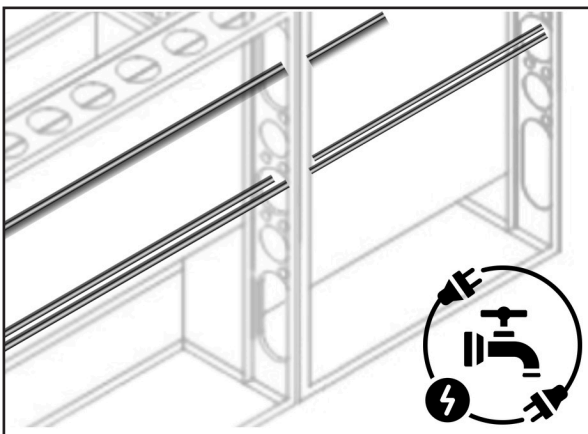

Bar die is now ready for contractors to complete plumbing, electrical & beverage connections.

Step 10: Finishing Work

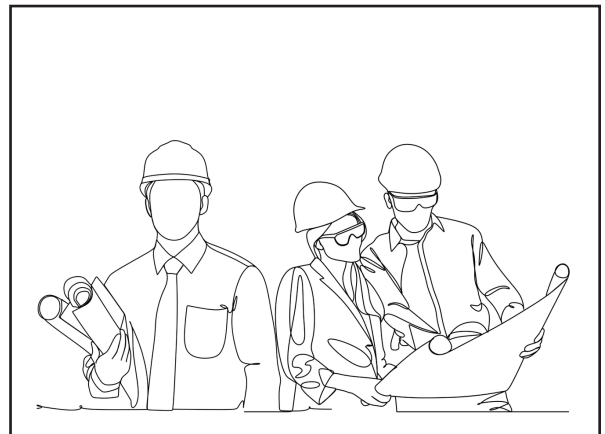

Flooring, mill work, and bar top can now be installed by the appropriate trades.